



Cisco/Linksys SPA8000 Series Analog Telephone Adapter

Account Setup

Publication History

Date	Version	Author
=====	=====	=====
August 24th, 2017	1	Jeffrey K Brady

2000-2017 Ironton Telephone Co

Proprietary

© All rights reserved.

Information subject to change without notice.

The information disclosed herein is proprietary to Ironton Telephone Company or others and is not to be used by or disclosed to unauthorized persons without the written consent of Ironton Telephone Company. The recipient of this document shall respect the security status of the information.

Cisco/Linksys SPA8000 Series Analog Telephone Adapters:

1. Access the Sip Device's IP Address.

A. Using for a Fax machine.

I. Connect an analog phone to the phone port of the ATA. 



B. Accessing the Analog Terminal Adapters IVR.

I. Press the star key four times: ********

a. The greeting plays.

C. Enter Code.

I. Press 100.

II. Press the # (pound) key to indicate that you have finished entering the code.

a. The IP address will be announced.

2. Accessing the Web Interface.

A. Enter the IP address into the web browser address bar.

B. The Login screen will appear.

I. Enter the Username in the text field. 

II. Enter the Password in the text field. 

III. Select the "OK" button. 

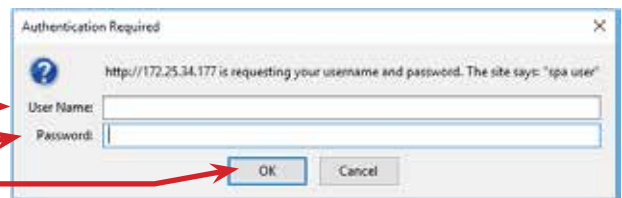

C. The User Status Screen will open.

I. Select the Voice Tab. 

II. Select Admin Login. 



D. The Voice Info Screen will open.

I. The system programming tabs will be available.

E. Select the desired line.

I. The Line Programming area will open. 

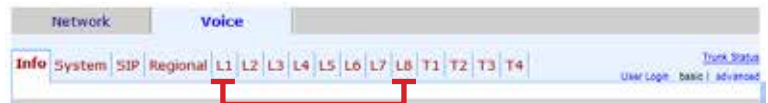

continued

3. Programming the line.

A. Line Enable.

- I. Select "yes" in the drop-down menu.



B. SIP port.

- I. Do not change this entry.

C. Proxy:

- I. Enter the SIP Server domain in the text box..

II. sip.itcgn.com

D. Register.

- I. Select "yes" in the drop-down menu.



E. Register Expires.

- I. Do not change this entry from 3600.

F. Display Name.

- The local name showing showing on other SIP devices when called within the switch.

I. Options.

- a. Phone number.
- b. Users Name.
- c. and / or Extension Number.

G. User ID

- The Account ID provided in the Welcome Letter.
 - 11 Digit Phone number.

H. Password:

- I. The Service Password provided in the Welcome Letter.

I. Use Auth ID.

- I. Select "yes" in the drop-down menu.



J. Auth ID

- The Account ID provided in the Welcome Letter.
 - 11 Digit Phone number.

K. Select the Submit All Changes button at the bottom of the page when finished.

Undo All Changes

Submit All Changes

- I. Select the Undo All Chnages button to remove entries.

- **Note:**

- Repeat Section 2-E & Section 3 until all of the lines are programmed.

